

# CastleHaven

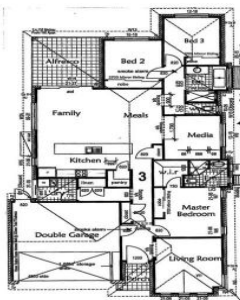

- ALL HOUSE AND LAND PACKAGES COME COMPLETE WITH THE FOLLOWING:-  
\$3,285,000
- INTERNAL:**
- CERAMIC FLOOR TILES AS SPECIFIED
  - CARPET ALLOWANCE \$2000
  - JOHN STONE BENCHTOPS TO KITCHEN & VANITIES
  - WITNESS DANA TONEL ROUTES
  - DOORING WITH PANELFIT GARAGE DOOR WITH REMOTE CONTROL
  - GARDENBROUGH LEVER INTERNAL DOOR FURNITURE
  - GARDENBROUGH TRUCKE CONTEMPORARY FRONT ENTRY DOOR LOCK
  - MESS TAPS THROUGHOUT HOME (KITCHEN & LAVASIN) WITH FULL OUT SPRAI
  - 2 HEAT / FAN LIGHT TO BATHROOM & ENSUITE
  - ONE INTERNAL GAS HEATING POINT
  - 2 TELEPHONE POINTS & 2 TELEVISION POINT
  - INSULATION TO CEILING OF LIVING AREAS & EXTERNAL WALLS
  - 200mm HIGH CEILING
  - ALARM SYSTEM
- APPLIANCES:**
- BUILDING STAINLESS STEEL OVEN
  - GAS STAINLESS STEEL COOK TOP
  - STAINLESS STEEL RANGEHOOD
  - HOT WATER - GAS - EXTERNAL INSTANTANEOUS 20 LITRE
  - RAINY / BUSTON HEATING COILS ARE CONDITIONING WITH 2 ZONES
- EXTERNAL:**
- LANDSCAPING TO FRONT & REAR TO THE PONDS STANDARDS
  - TILED ALFRESCO COMPLETE WITH GAS BBQ POINT, POWER POINT & CEILING FAN
  - CONCRETE TO DRIVEWAY - (coloured to suit, refer to sheet)
  - FENCING
  - LETTERBOX
  - CLOTHESLINE
- PLEASE NOTE THAT NO OTHER ALKIRA HOME PACKAGES ARE INCLUDED



## 12 Jezebel Street The Ponds NSW

4 🏠 2 🚗 2 🚗

New home offering formal living, casual family/meals area adjoining designer kitchen with stone benchtops, stainless steel appliances and a walk-in pantry. Three bedrooms plus an easily converted media room. Open plan living areas and tiled alfresco area. The master bedroom includes an ensuite bathroom. Includes carpet allowance, tiles and auto double garage with internal access, ducted air conditioning, full landscaping, fencing and driveway. Beautifully situated on a level block opposite a passive reserve.

**View :** <https://www.castlehaven.com.au/sale/nsw/hills/th-e-ponds/residential/house/5735117>



**Castlehaven Realtors**  
02 9634 5222